

2hp Tape Stop

Clock-Synced Tape Effect

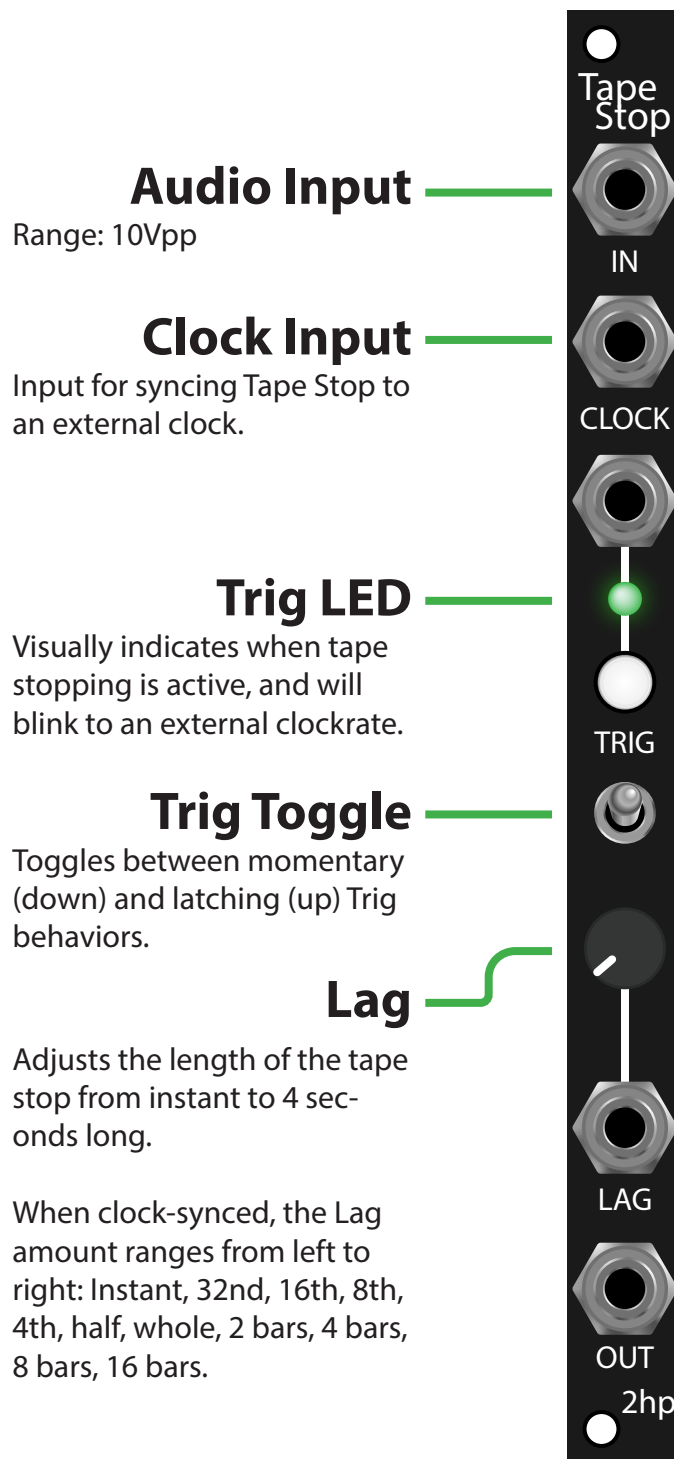

Tech Specs

Width: 2HP
Depth: 46mm
Power Consumption:
+12V=101mA, -12V=7mA,
+5V=0mA

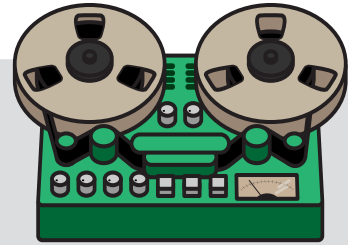

Watch The Demo

Trig Gate Input

Threshold: 0.4V

Trig

Pressing Trig will begin the tape stop. In Momentary mode, the tape stop will end when the button is released. In Latching mode, the button must be pressed a second time to end the tape stop.

Lag CV Input

Range: -5V to +5V

Audio Output

Range: 10Vpp

50/50 Mode

Holding the Trig button at boot up will set the dry wet mix on Tape Stop to 50%, allowing you to hear the dry signal while tape stopping!

Module Installation

- To install your 2hp module, locate a space with the appropriate HP in your rack for installation.
- Next, connect the module's power cable to your power supply. The cables on this end are keyed, though you should make sure to align the red stripes on both connectors to ensure safe and proper connection. Our illustration uses a flying bus cable, though the same action applies for busboards/alternate power solutions. See the figure below for reference:

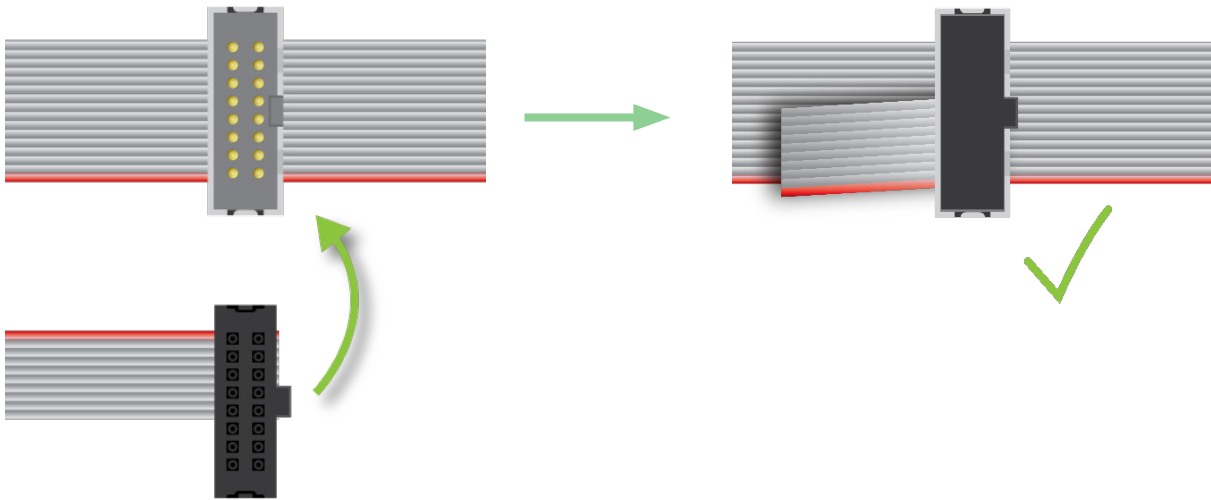

- Next, make sure your module's power cable is properly connected to your module. For 2hp modules, confirm that your cable's red stripe aligns with the white marker line on the module's PCB, just above the power header. You may notice that even though there is only 1 row of 5 pins on your 2hp module, but 2 rows on the power cable. You can use either row of 5 pin connectors on the cable with your module, so long as the red stripe is properly aligned. See figure below for reference:

- Finally, mount your module to the rails using compatible mounting screws. Your module is now ready to be powered on and patched!

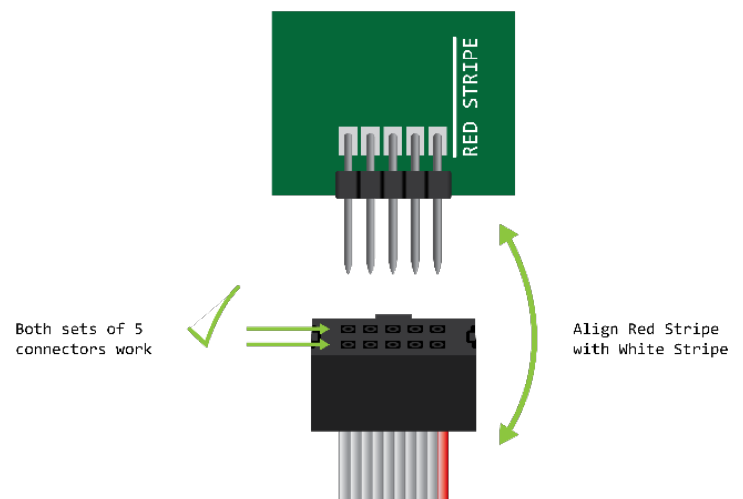

Module Pairings

Tape Stop is a fun effect for any sound, but here are a few considerations from our line up that we think work great with Tape Stop!



Lo-Fi

Boost your analog sonic character by pairing Tape Stop with Lo-Fi!

Use the analog mode to introduce wow & flutter, white noise hiss, and sporadic pops and crackles to give your tape stops a vintage, authentic feel.

Play

Stop samples with style by throwing Play before Tape Stop in the signal chain!



Loop

Whether before or after Tape Stop, Loop is an excellent addition for building massive loops to gradually stop, or record creative tape stopping to chop up a loop!

VCA

If you want even more mixing control than 50/50 mode offers, mult your audio signal and run the dry and wet signals separately into our dual VCA!

Remember: you can never have too many VCAs!

